

L I F E   C A N ' T   W A I T



ADDRESS EAST

DORRA

# We Are Dorra

---

For over 70 years, Dorra Group have been building and developing the Egyptian real estate landscape and laying down the tarmac for the growth of the industry we see today. Pioneers in the construction, development and tourism fields, Dorra Group have witnessed a change in the Egyptian economic, social and governing bodies since 1943 and have continued to evolve and adapt with the market.

Continually striving to develop their communities, Dorra Group today spearheaded by Dorra Developments, have entered a new era in providing residential and mixed use projects to the market place that is masterfully constructed, finished and designed as well as maintained and serviced throughout projects.



# DORRA





# Your Address East

Over 60 acres, Address East induced to the market a volume of 1748 fully finished apartments, duplexes, twin houses and separate villas. Apartments size ranging from 121 m<sup>2</sup> up to 180 m<sup>2</sup>, duplex 210 m<sup>2</sup>, twin house 315 m<sup>2</sup>. Address East is the perfect choice for newly married couples and young families looking for accessible yet uncompromisingly stylish homes.

ADDRESS EAST





L I F E   C A N ' T   W A I T





# The Address Life



RETAIL STRIP



RESTAURANTS





UNDERGROUND PARKING



KIDS AREA



JOGGING TRACK



SURVEILLANCE SYSTEM



SPA



CLUBHOUSE



ZEN GARDENS



# East Clubhouse

Positioned at the heart of Address East, East Club House has been designed by award winning interior designers to offer that extra sense of exclusivity and lush experience. Open to all tenants of Address East and their visitors, East Club House will provide the convenience, service and comfort of your home yet set in a leisure and modern ambience.





# East Spa

---

Privately nestled away at the UFC gym, is our East Spa retreat, specially designed for you to relax, re-aligned and re-energized. Managed by a leading spa and health provider, we will ensure that your experience at Address East will be the most indulgent spa treat you can imagine.



# Zen Gardens

---

Inspired by the art and placement of Feng Shui, Address East will be home to some of the most inspiring, relaxing and mediation centric gardens and open areas. Good Feng Shui in your garden will attract positive energy to your everyday living as well as delight your senses.





# East Strip : Cafés and Eateries

Neatly aligned on East Strip, we have hand picked some of the most sought after cafes and restaurants in Cairo and have brought them to Address East, where dining experiences, casual encounters and quality alone time can be spent only steps away from your residence



The above mentioned brands have shown an interest to be part of the commercial community Address East by signing a cooperation protocol.

ADDRESS EAST



# Welcome Home

10 minutes away from AUC  
20 minutes away from Heliopolis and Nasr City  
15 minutes away from Cairo Airport  
5 minutes away from New Administrative Capital  
0 minutes away from your dream

Address East is located within the urban suburbs of East Cairo, only 5 minutes away with direct access from the main Suez road.





# The Project

---

A contemporary and modern design, incorporating aesthetically pleasing architectural structures that are subtly influenced with a modern arabesque flair. Address East will provide the luxurious and exclusive comforts for our community to reside in amidst a tranquil environment. Our fully finished apartments and duplex's have been meticulously designed to meet and exceed expectations.

ADDRESS EAST

---









# Master Plan

- 
- 1,748 units comprising of 88 apartment building, 24 twin houses and 8 limited detached villas.
  - 60 acres.
  - 80% of development devoted to common areas and private gardens.
  - East Strip







# BUILDING TYPE 1

DUPLEX UNIT 210 M<sup>2</sup>

ADDRESS EAST

01-	Reception	3.72x4.98 m <sup>2</sup>
02-	Living	3.61x4.52 m <sup>2</sup>
03-	Dining	3.60x4.05 m <sup>2</sup>
04-	Kitchen	1.64/2.90x2.70/4.72 m <sup>2</sup>
05-	Guest Toilet	1.77x3.72 m <sup>2</sup>
06-	Terrace	1.11x3.83 m <sup>2</sup>
07-	Master Bedroom	3.60x3.93 m <sup>2</sup>
08-	Walk-In Closet	1.60x1.77 m <sup>2</sup>
09-	Bathroom	1.77x2.00 m <sup>2</sup>
10-	Bedroom 1	3.60x3.78 m <sup>2</sup>
11-	Bedroom 2	3.61x4.40 m <sup>2</sup>
12-	Bathroom	2.00x2.90 m <sup>2</sup>
13-	Kicthenette	2.14x2.83 m <sup>2</sup>
14-	Corridor	(1.14x2.39)/(1.33x2.98) m <sup>2</sup>
15-	Terrace	(1.73x3.41)/(1.47x2.94) m <sup>2</sup>



GROUND FLOOR



FIRST FLOOR

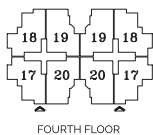

FOURTH FLOOR

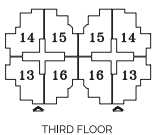

THIRD FLOOR

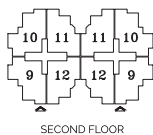

SECOND FLOOR

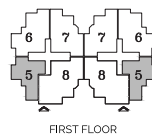

FIRST FLOOR

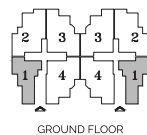

GROUND FLOOR



# BUILDING TYPE 1

140 M<sup>2</sup>

ADDRESS EAST

01-	Reception & Dining	3.70x7.18 m <sup>2</sup>
02-	Kitchen	2.13/2.9x4.24 m <sup>2</sup>
03-	Master Bedroom	3.60x3.93 m <sup>2</sup>
04-	Bathroom	1.77x2.00 m <sup>2</sup>
05-	Walk-In Closet	1.60x1.77 m <sup>2</sup>
06-	Bedroom 1	3.60x3.78 m <sup>2</sup>
07-	Bedroom 2	3.61x4.40 m <sup>2</sup>
08-	Bathroom	2.20x2.83 m <sup>2</sup>
09-	Corridor 1	1.26x2.92 m <sup>2</sup>
10-	Corridor 2	1.15x2.97 m <sup>2</sup>
11-	Terrace	1.97x3.81 m <sup>2</sup>
12-	Terrace	1.73x1.94 m <sup>2</sup>

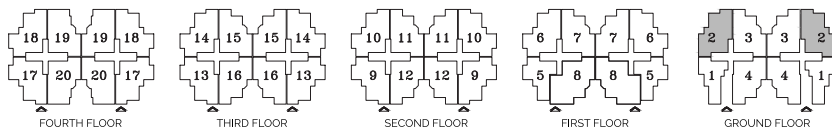

# BUILDING TYPE 1

145 M<sup>2</sup>

ADDRESS EAST

01-	Reception & Dining	3.70x7.18 m <sup>2</sup>
02-	Kitchen	2.13/2.9x4.24 m <sup>2</sup>
03-	Master Bedroom	3.60x3.93 m <sup>2</sup>
04-	Bathroom	1.77x2.00 m <sup>2</sup>
05-	Walk-In Closet	1.60x1.77 m <sup>2</sup>
06-	Bedroom 1	3.60x3.78 m <sup>2</sup>
07-	Bedroom 2	3.61x4.40 m <sup>2</sup>
08-	Bathroom	2.20x2.83 m <sup>2</sup>
09-	Corridor 1	1.26x2.92 m <sup>2</sup>
10-	Corridor 2	1.15x2.97 m <sup>2</sup>
11-	Terrace	1.97x3.81 m <sup>2</sup>
12-	Terrace	(1.73x1.94)+(1.42x4.72) m <sup>2</sup>

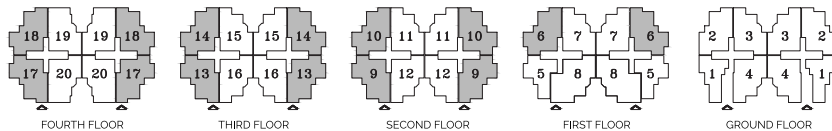



# BUILDING TYPE 1

140 M<sup>2</sup>

ADDRESS EAST

01-	Reception & Dining	3.70x7.18 m <sup>2</sup>
02-	Kitchen	2.83x3.82 m <sup>2</sup>
03-	Master Bedroom	3.60x3.93 m <sup>2</sup>
04-	Bathroom	1.77x2.21 m <sup>2</sup>
05-	Walk-In Closet	1.60x1.77 m <sup>2</sup>
06-	Bedroom 1	3.60x3.78 m <sup>2</sup>
07-	Bedroom 2	3.60x3.61 m <sup>2</sup>
08-	Bathroom	2.30x2.83 m <sup>2</sup>
09-	Corridor 1	1.26x2.92 m <sup>2</sup>
10-	Corridor 2	1.25x6.11 m <sup>2</sup>
11-	Terrace	1.56x1.73 m <sup>2</sup>
12-	Terrace	1.97x3.80 m <sup>2</sup>

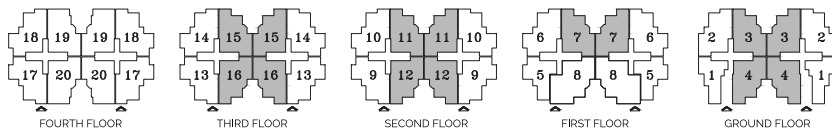

# BUILDING TYPE 1

180 M<sup>2</sup>

ADDRESS EAST

01-	Reception, Living & Dining	7.18x7.70 m <sup>2</sup>
02-	Kitchen	2.83x3.82 m <sup>2</sup>
03-	Master Bedroom	3.60x3.93 m <sup>2</sup>
04-	Bathroom	1.77x2.21 m <sup>2</sup>
05-	Walk-In Closet	1.60x1.77 m <sup>2</sup>
06-	Bedroom 1	3.60x3.78 m <sup>2</sup>
07-	Bedroom 2	3.60x3.61 m <sup>2</sup>
08-	Bathroom	2.30x2.83 m <sup>2</sup>
09-	Corridor 1	1.26x2.92 m <sup>2</sup>
10-	Corridor 2	1.25x6.11 m <sup>2</sup>
11-	Terrace	1.57x1.73 m <sup>2</sup>
12-	Terrace	1.97x7.86 m <sup>2</sup>

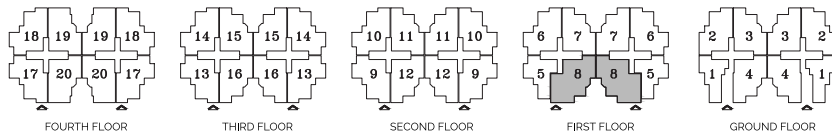



# BUILDING TYPE 1

147 M<sup>2</sup>

ADDRESS EAST

01-	Reception & Dining	3.70x7.18 m <sup>2</sup>
02-	Kitchen	2.83x3.82 m <sup>2</sup>
03-	Master Bedroom	3.60x3.93 m <sup>2</sup>
04-	Bathroom	1.77x2.21 m <sup>2</sup>
05-	Walk-In Closet	1.60x1.77 m <sup>2</sup>
06-	Bedroom 1	3.60x3.78 m <sup>2</sup>
07-	Bedroom 2	3.60x3.61 m <sup>2</sup>
08-	Bathroom	2.30x2.83 m <sup>2</sup>
09-	Corridor 1	1.26x2.92 m <sup>2</sup>
10-	Corridor 2	1.25x6.11 m <sup>2</sup>
11-	Terrace	1.57x1.73 m <sup>2</sup>
12-	Terrace	1.97x7.06 m <sup>2</sup>

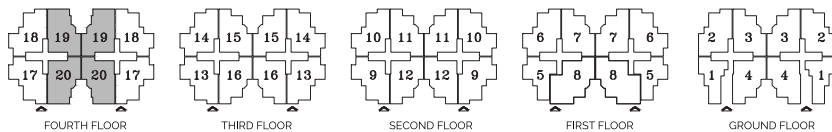

# BUILDING TYPE 2

121 M<sup>2</sup>

ADDRESS EAST

01-	Reception & Dining	4.65x5.94 m <sup>2</sup>
02-	Kitchen	2.88x2.93 m <sup>2</sup>
03-	Master Bedroom	4.10x5.00 m <sup>2</sup>
04-	Bedroom 1	4.00x4.00 m <sup>2</sup>
05-	Bathroom	2.41x3.00 m <sup>2</sup>
06-	Corridor 1	1.33x4.13 m <sup>2</sup>
07-	Corridor 2	1.25x3.35 m <sup>2</sup>
08-	Terrace	1.60x1.74 m <sup>2</sup>
09-	Terrace	1.11x4.11 m <sup>2</sup>

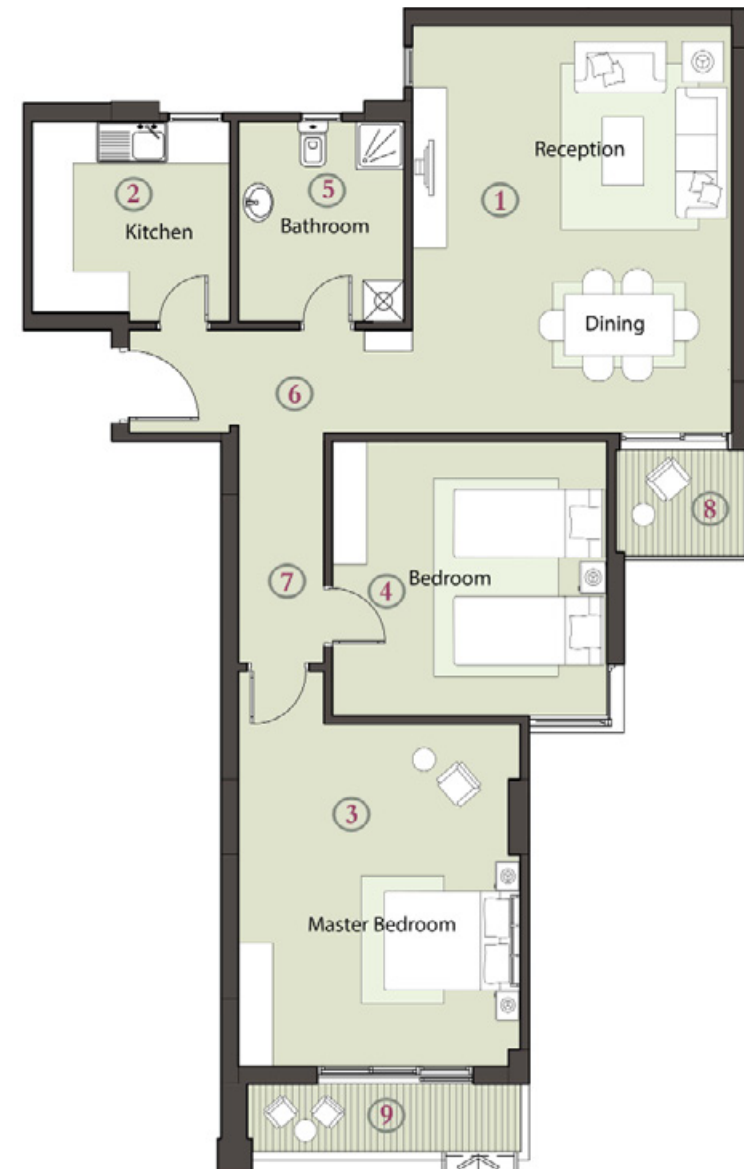
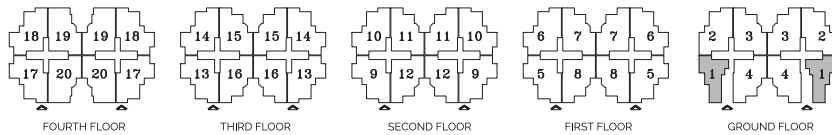



# BUILDING TYPE 2

163 M<sup>2</sup>

ADDRESS EAST

01-	Reception & Dining	4.00x8.10 m <sup>2</sup>
02-	Kitchen	3.14x3.48 m <sup>2</sup>
03-	Master Bedroom	4.00x4.17 m <sup>2</sup>
04-	Bathroom	1.82x2.56 m <sup>2</sup>
05-	Walk-In Closet	1.82x1.97 m <sup>2</sup>
06-	Bedroom 1	4.00x4.00 m <sup>2</sup>
07-	Bedroom 2	4.10x5.00 m <sup>2</sup>
08-	Bathroom	2.30x3.27 m <sup>2</sup>
09-	Corridor 1	1.25x3.04 m <sup>2</sup>
10-	Corridor 2	1.25x5.77 m <sup>2</sup>
11-	Terrace	1.73x1.94 m <sup>2</sup>
12-	Terrace	2.10x3.88 m <sup>2</sup>

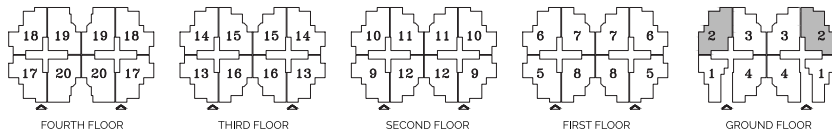

# BUILDING TYPE 2

171 M<sup>2</sup>

ADDRESS EAST

01-	Reception & Dining	4.00x8.10 m <sup>2</sup>
02-	Kitchen	3.14x3.48 m <sup>2</sup>
03-	Master Bedroom	4.00x4.17 m <sup>2</sup>
04-	Bathroom	1.82x2.56 m <sup>2</sup>
05-	Walk-In Closet	1.82x1.97 m <sup>2</sup>
06-	Bedroom 1	4.00x4.00 m <sup>2</sup>
07-	Bedroom 2	4.10x5.00 m <sup>2</sup>
08-	Bathroom	2.30x3.27 m <sup>2</sup>
09-	Corridor 1	1.25x3.29 m <sup>2</sup>
10-	Corridor 2	1.25x5.77 m <sup>2</sup>
11-	Terrace	(1.47x4.72)+(1.73x1.94) m <sup>2</sup>
12-	Terrace	2.10x3.88 m <sup>2</sup>

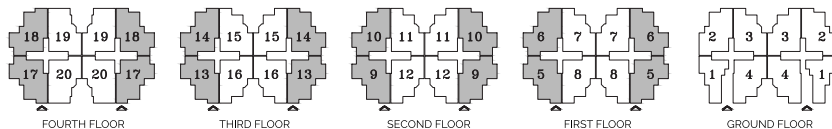



# BUILDING TYPE 2

160 M<sup>2</sup>

ADDRESS EAST

01-	Reception & Dining	4.00x8.10 m <sup>2</sup>
02-	Kitchen	3.14x3.92 m <sup>2</sup>
03-	Master Bedroom	4.00x4.00 m <sup>2</sup>
04-	Bathroom	1.82x2.08 m <sup>2</sup>
05-	Walk-In Closet	1.80x1.82 m <sup>2</sup>
06-	Bedroom 1	4.00x4.00 m <sup>2</sup>
07-	Bedroom 2	4.00x4.10 m <sup>2</sup>
08-	Bathroom	2.30x3.27 m <sup>2</sup>
09-	Corridor 1	1.25x3.29 m <sup>2</sup>
10-	Corridor 2	1.25x5.77 m <sup>2</sup>
11-	Terrace	1.52x1.73 m <sup>2</sup>
12-	Terrace	2.10x4.00 m <sup>2</sup>

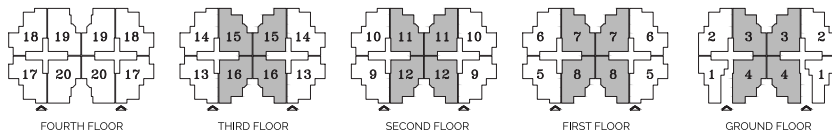

# BUILDING TYPE 2

167 M<sup>2</sup>

ADDRESS EAST

01-	Reception & Dining	4.00x8.10 m <sup>2</sup>
02-	Kitchen	3.14x3.92 m <sup>2</sup>
03-	Master Bedroom	4.00x4.00 m <sup>2</sup>
04-	Bathroom	1.81x2.08 m <sup>2</sup>
05-	Walk-In Closet	1.80x1.81 m <sup>2</sup>
06-	Bedroom 1	4.00x4.00 m <sup>2</sup>
07-	Bedroom 2	4.00x4.10 m <sup>2</sup>
08-	Bathroom	2.30x3.27 m <sup>2</sup>
09-	Corridor 1	1.25x3.30 m <sup>2</sup>
10-	Corridor 2	1.25x5.77 m <sup>2</sup>
11-	Terrace	1.52x1.73 m <sup>2</sup>
12-	Terrace	2.10x7.34 m <sup>2</sup>

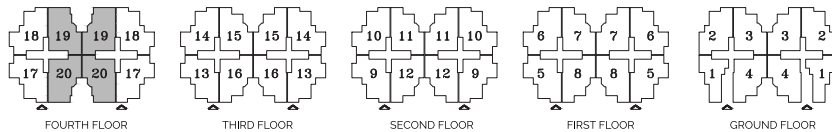





L I F E   C A N ' T   W A I T   A T

